

Explorer BX-40 / BX-33 Ball head

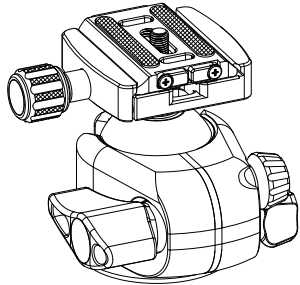

Specifications

Body Material	Aluminum	Base Diameter	BX-40 (52mm) BX-33 (45mm)
Ball Diameter	BX-40 (40mm) BX-33 (33mm)	Height	BX-40 (77mm) BX-33 (74mm)
Base Thread Socket	UNC 3/8" - 16	Net Weight	BX-40 (390g) BX-33 (330g)

Components

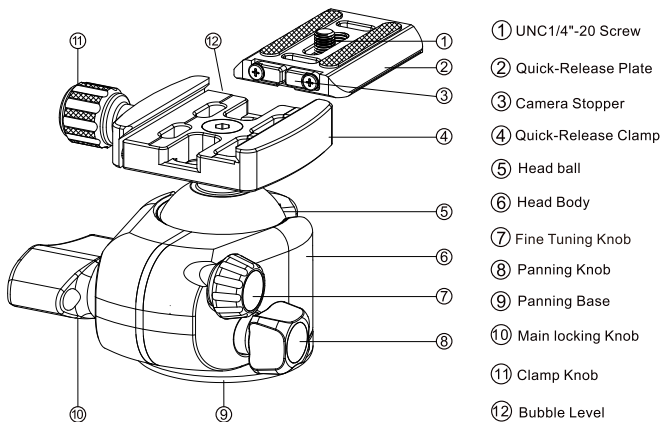

Maintenance

1. Prevent the ball head from getting fouled in mud, dirt or sand
2. Blow off any sand or dust, or wipe it off with a soft cloth
3. Rinse any mud or dirt and dry it thoroughly
4. Do not submerge the ball head in liquid
5. Do not apply any lubricant
6. Do not remove any of the knobs. this can damage the threads and ball locking mechanism.

Installation

Mounting the ball head

1. Tighten the panning lock knob
2. Screw the ball head onto the 3/8"/20 screw in a clockwise direction until secure. Do not over tighten as this can damage the ball head mount and the tripod screw.

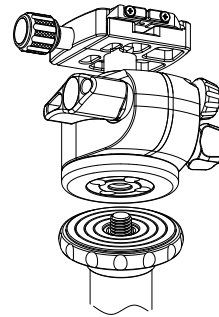

Mounting the camera

1. Mount the quick release plate to the bottom of the camera via the 1/4"/20 screw. Apply tension until plate is secure however do not over torque as this can result in damage to the camera.
2. If added stability is required to prevent the camera from twisting on the plate the stopper tabs can be raised as per the illustration below to secure the camera.
3. Once the plate is secure the camera can be added to the ball head clamp. Firstly make sure the clamp is fully opened by rotating the locking knob anti clockwise.
4. with the camera and plate mounted to the clamp secure the clamp shut by rotating the locking knob clockwise until the camera and plate is secure in the clamp.

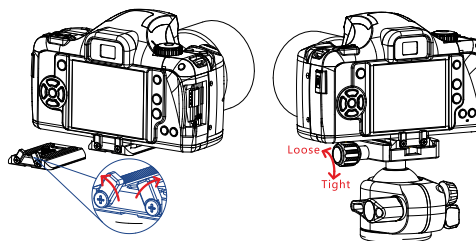

Operating Instructions

Main locking knob

To change the angle of the camera unlock the main locking knob to release the tension on the ball. Re position the camera to the desired angle and composition and re tighten the main lock knob to fix the camera in place.

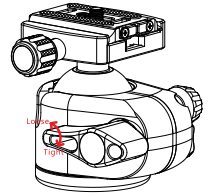

Fine tuning knob

The fine tuning knob can be adjusted to add more or less tension to the ball. More tension on the ball assists when using larger setups to control the weight and movement of the camera and lens.

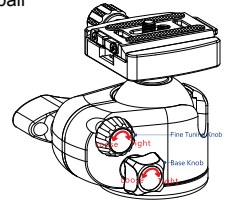

Panning base adjustment

By turning the panning base locking knob anti clockwise the panning base will be released allowing for free panning motion. To lock the panning base at the desired rotation simply lock the panning base lock knob by turning it clockwise until the know is secure.

Warranty

Explorer Photo & Video warrants its products with a 5 year limited warranty. Please visit our webpage for all warranty details - Explorerphotovideo.com.au

Notes

1. Working temperature -40C- 60C
- 2.Ensure all knobs are secure before taking your hand off the camera
3. Do not use the ball head for anything other than its intended use

EXPLORE | CAPTURE | CREATE

Follow us on Instagram

@explorerphotovideo



Explorer Photo and Video

Sydney, Australia

Los Angeles, United States of America

W: explorerphotovideo.com

E: hello@explorerphotovideo.com